

ZONING MAP, TOWN OF HOLLAND, SHEBOYGAN COUNTY, WI

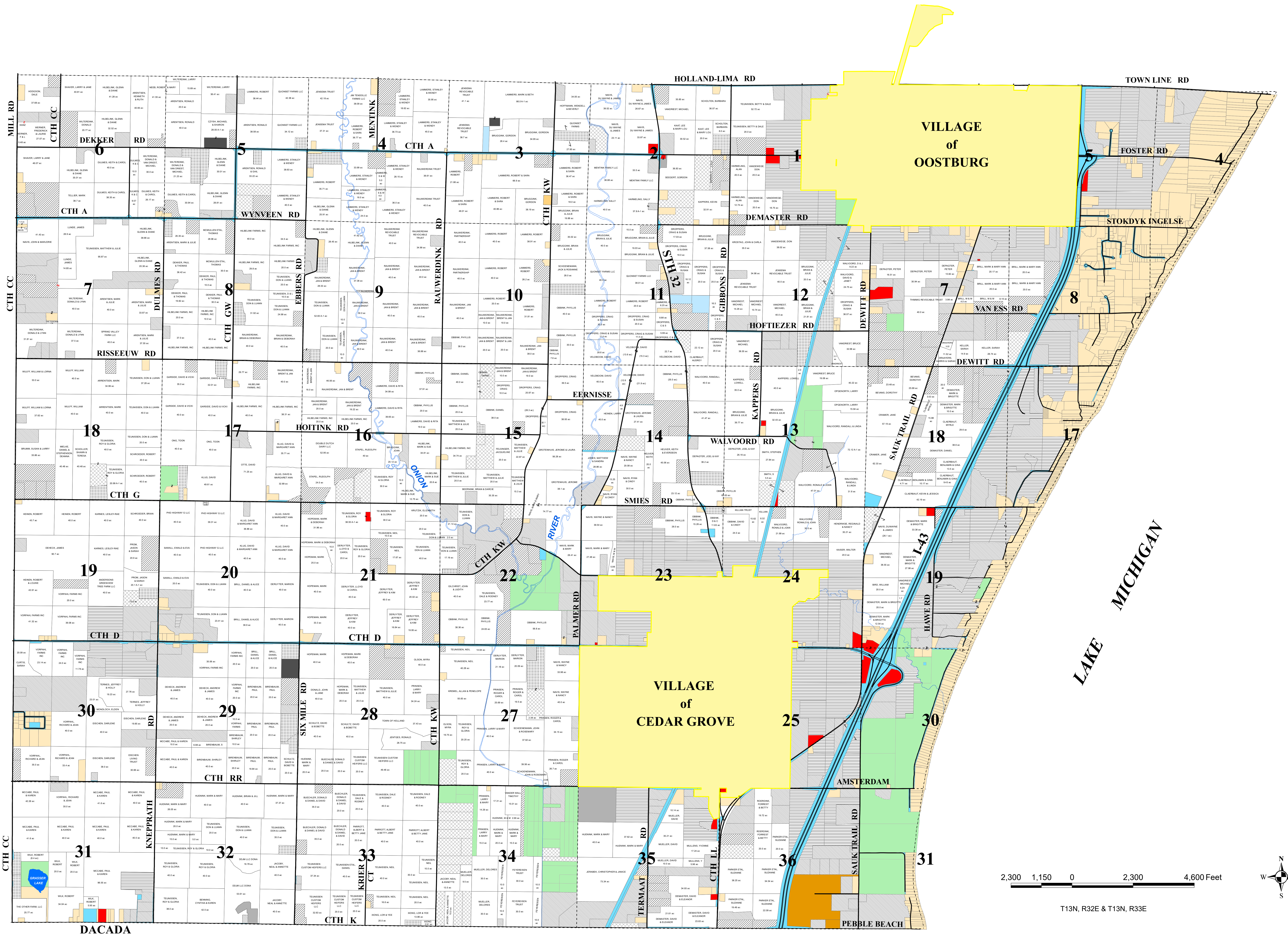

LEGEND Zoning Districts

A-1*
 A-1-S*
 A-PR*

A-2
 A-3
 A-5

B-1
 C-1
 M-1
 M-3

P-1
 P-2

R-1
 R-2
 R-4
 R-5

N or ↘
 indicates a
 single tax parcel

*within FPZ

Map prepared by:
UW-Extension Sheboygan County for rezonings up through 12/31/20

Zoning boundaries were compiled from information provided by the Town of Holland. Sheboygan County does not have countywide general land use zoning and therefore has no jurisdiction relative to this map. Questions should be directed to the Town of Holland Clerk.

This map is not a survey of the actual boundary of any property this map depicts.

